

# Soils Map

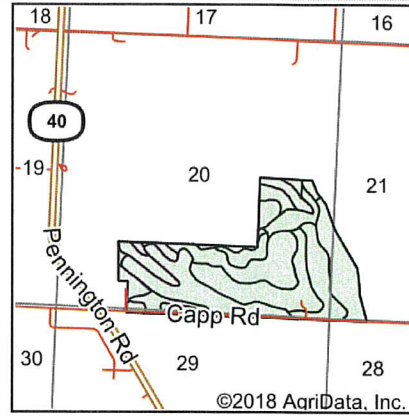
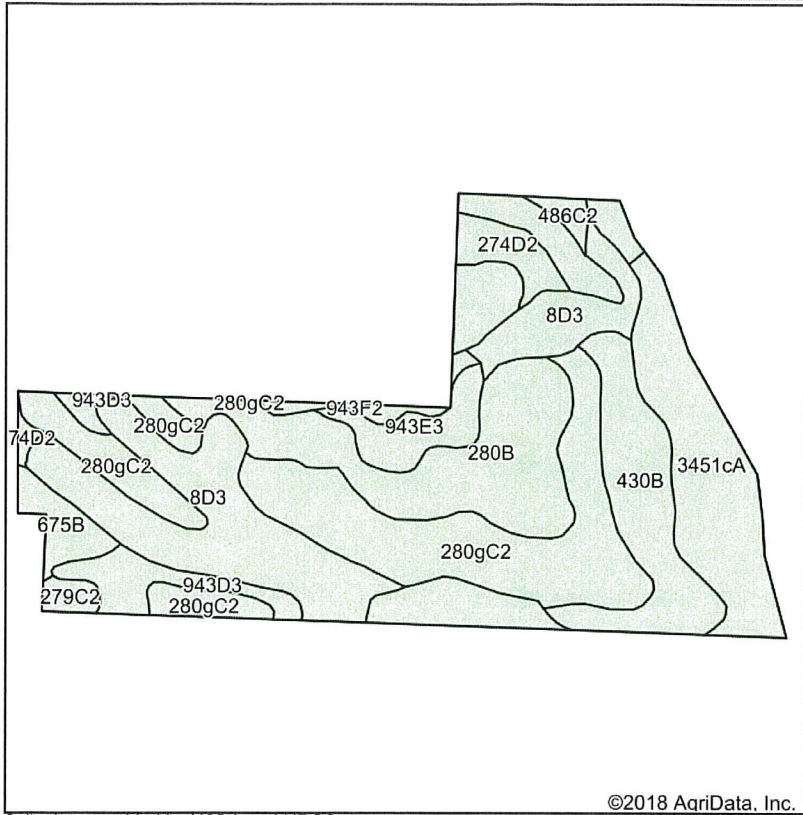

State: **Illinois**  
 County: **Whiteside**  
 Location: **20-22N-7E**  
 Township: **Jordan**  
 Acres: **180.63**  
 Date: **12/6/2018**

©2018 AgriData, Inc.

Maps Provided By:

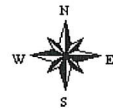

Soils data provided by USDA and NRCS.

Area Symbol: IL195, Soil Area Version: 15

Code	Soil Description	Acres	Percent of field	Il. State Productivity Index Legend	Corn Bu/A	Soybeans Bu/A	Wheat Bu/A	Crop productivity index for optimum management
**280gC2	Fayette silt loam, glaciated, 5 to 10 percent slopes, eroded	49.32	27.3%		**155	**49	**61	**113
**8D3	Hickory clay loam, 10 to 18 percent slopes, severely eroded	33.24	18.4%		**98	**33	**40	**75
3451cA	Lawson silt loam, cool mesic, 0 to 2 percent slopes, frequently flooded	27.25	15.1%		190	61	73	140
**280B	Fayette silt loam, glaciated, 2 to 5 percent slopes	26.19	14.5%		**165	**52	**65	**121
**430B	Raddle silt loam, 2 to 5 percent slopes	17.12	9.5%		**187	**58	**72	**137
**943E3	Seaton-Timula silt loams, 18 to 25 percent slopes, severely eroded	6.11	3.4%		**110	**35	**42	**80
**943D3	Seaton-Timula silt loams, 10 to 18 percent slopes, severely eroded	6.01	3.3%		**131	**41	**50	**96
**274D2	Seaton silt loam, 10 to 18 percent slopes, eroded	4.85	2.7%		**148	**45	**57	**107
**675B	Greenbush silt loam, 2 to 5 percent slopes	4.13	2.3%		**182	**57	**69	**133
**943F2	Seaton-Timula silt loams, 18 to 35 percent slopes, eroded	1.97	1.1%		**107	**34	**41	**78
3415A	Orion silt loam, 0 to 2 percent slopes, frequently flooded	1.60	0.9%		180	57	66	131
**279C2	Rozetta silt loam, 5 to 10 percent slopes, eroded	1.57	0.9%		**153	**47	**60	**112
**486C2	Bertrand silt loam, 5 to 10 percent slopes, eroded	1.27	0.7%		**146	**47	**57	**106
<b>Weighted Average</b>					<b>152</b>	<b>48.4</b>	<b>59.4</b>	<b>111.8</b>

Table: Optimum Crop Productivity Ratings for Illinois Soil by K.R. Olson and J.M. Lang, Office of Research, AGES, University of Illinois at Champaign-Urbana. Version: 1/2/2012 Amended Table 32-50-11

Crop yields and productivity indices for optimum management (B811) are maintained at the following NRES web site:

<http://soilproductivity.nres.illinois.edu/>

\*\* Indexes adjusted for slope and erosion according to Bulletin 811 Table S3

\*c: Using Capabilities Class Dominant Condition Aggregation Method