

Soils Map

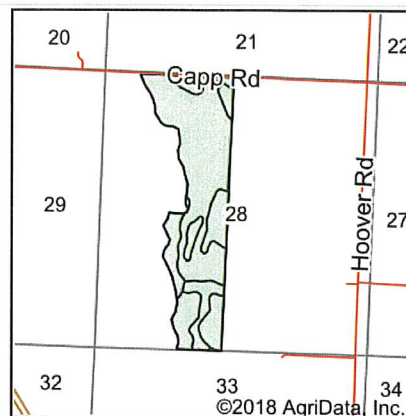

State: **Illinois**
 County: **Whiteside**
 Location: **28-22N-7E**
 Township: **Jordan**
 Acres: **132.56**
 Date: **12/10/2018**

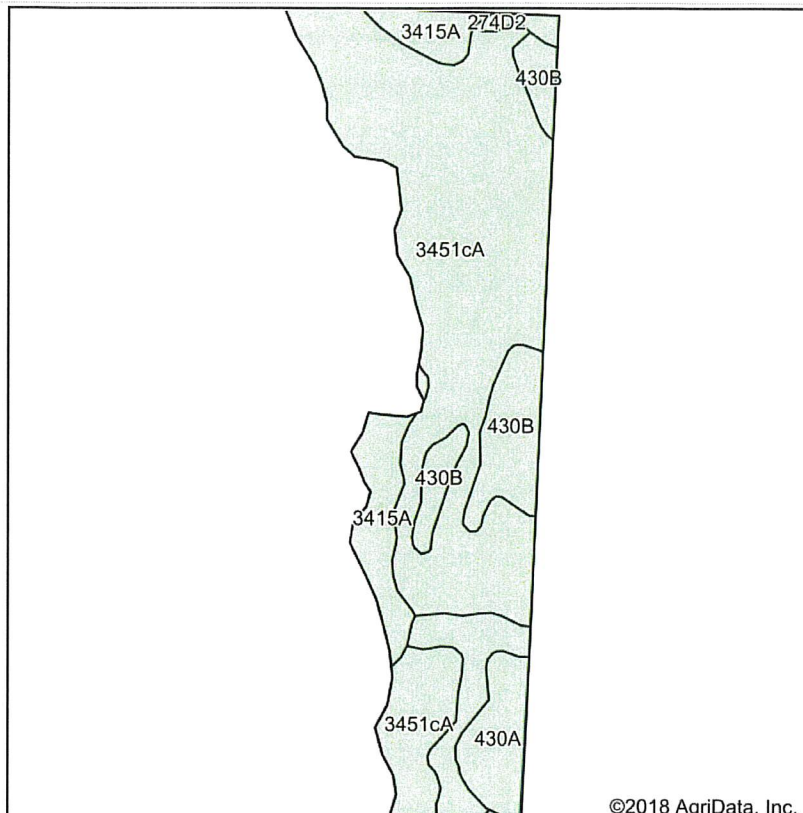

Soils data provided by USDA and NRCS.

Area Symbol: IL195, Soil Area Version: 15								
Code	Soil Description	Acres	Percent of field	Il. State Productivity Index Legend	Corn Bu/A	Soybeans Bu/A	Wheat Bu/A	Crop productivity index for optimum management
3451cA	Lawson silt loam, cool mesic, 0 to 2 percent slopes, frequently flooded	86.52	65.3%		190	61	73	140
**430B	Raddle silt loam, 2 to 5 percent slopes	23.60	17.8%		**187	**58	**72	**137
3415A	Orion silt loam, 0 to 2 percent slopes, frequently flooded	12.64	9.5%		180	57	66	131
430A	Raddle silt loam, 0 to 2 percent slopes	8.36	6.3%		189	59	73	138
**485B	Richwood silt loam, 2 to 5 percent slopes	0.91	0.7%		**184	**56	**70	**135
**274D2	Seaton silt loam, 10 to 18 percent slopes, eroded	0.53	0.4%		**148	**45	**57	**107
Weighted Average					188.2	59.9	72.1	138.3

Table: Optimum Crop Productivity Ratings for Illinois Soil by K.R. Olson and J.M. Lang, Office of Research, ACES, University of Illinois at Champaign-Urbana. Version: 1/2/2012 Amended Table S2 B811

Crop yields and productivity indices for optimum management (B811) are maintained at the following NRES web site:

<http://soilproductivity.nres.illinois.edu/>

** Indexes adjusted for slope and erosion according to Bulletin 811 Table S3

*c: Using Capabilities Class Dominant Condition Aggregation Method